

UNAUTHORIZED USE OF THIS
DRAWING IS STRICTLY PROHIBITED

DAR	REV	DESCRIPTION	APPVD	DATE
5159	E	SEE DAR	DG	9-14
6341	F	SEE DAR	DG	7-16
6390	G	SEE DAR	TJD	8-16

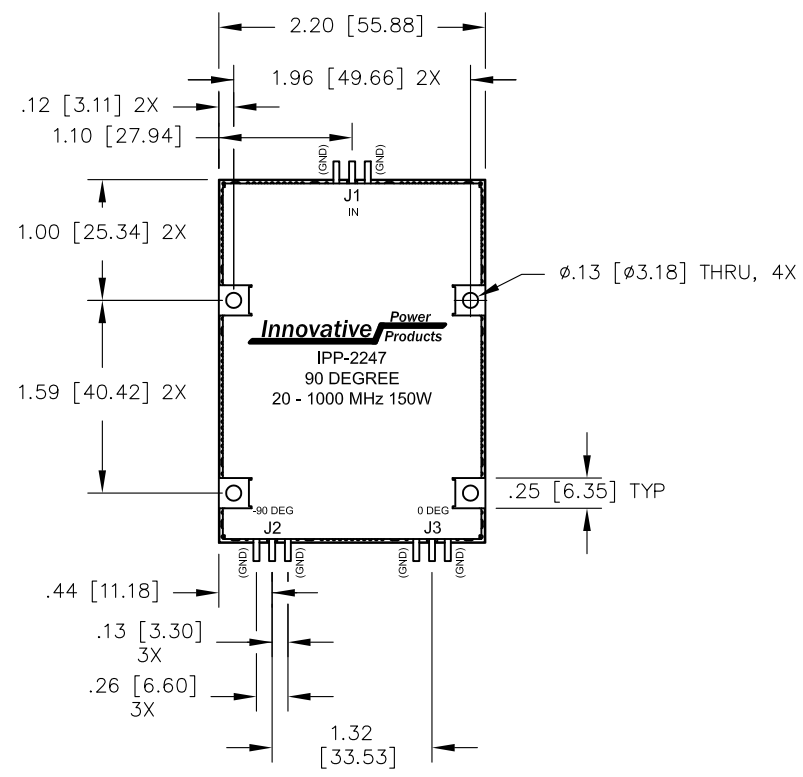
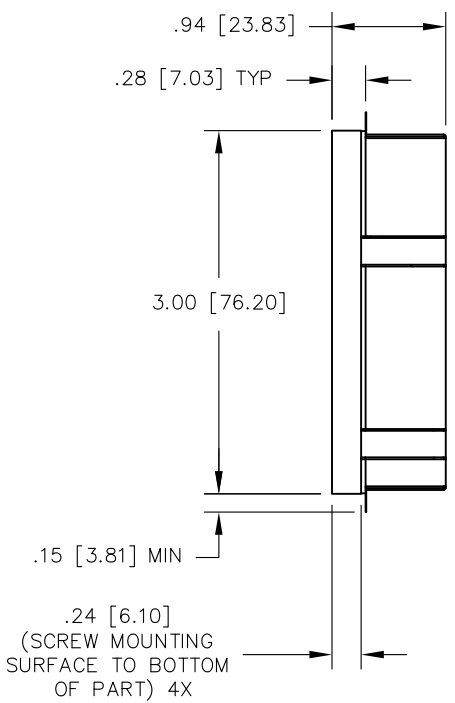

- NOTES:**
- LEADS: 99.99% PURE SILVER .050 [1.270] X .005 [.127] THICK.
 - DATA AND SPECIFICATIONS APPLY WHEN PART IS MOUNTED IN IPP TEST FIXTURE TF-1152. TEST CONFIGURATION/FOOTPRINT AVAILABLE ON REQUEST.
 - RoHS COMPLIANT.

ELECTRICAL SPECIFICATIONS

FREQUENCY:	20 - 1000 MHz.
INSERTION LOSS:	< 0.90 dB
VSWR:	< 1.3:1
PHASE BALANCE:	±12°
AMPLITUDE BALANCE:	±0.25 dB
POWER:	150 WATT
ISOLATION:	>16 dB
TEMPERATURE:	-55°C TO +85°C

PORT CONFIGURATION

INPUT	J1	J2	J3
J1	---	-3dB<-90 DEG	-3dB<0 DEG

MATERIAL AL. ALLOY 6061-T651	DWN	DG	DATE	6-10	Innovative Power Products
	ENG	TJD	DATE	6-10	
FINISH CHEM FILM, CLEAR, PER MIL-DTL-5541, TYPE 2, REV. F, CLASS 3 (ROHS COMPLIANT)	MANUF	DATE		TITLE OUTLINE, COUP., 90°, 20 - 1000 MHz. 150W	
	TOLERANCE .XX ±.02 .XXX ±.010 ANG. ±1/2°		CAGE CODE: 437R2		SIZE B
SHEET OF 1 1		SCALE	1:1	REV. G	